



**Outback Ready**

# User Manual

Model OB-25RDY



# Ready for Whatever Comes Your Way

With the Outback Ready, you can rest assured that you have the ability to provide your family and others with life-protecting, pure water. The Outback Ready is an easily portable and accessible gravity-powered water filtration system that effectively eliminates both organic and inorganic contaminants to ensure safe drinking water from any clear or fresh water source, even under the toughest conditions.

Designed to endure the rigors of disaster situations, Outback Ready is also ideal for food storage camping and other activities, which is why the Outback Ready system is widely trusted by relief, missionary, and government organizations, including the United States Peace Corps and organizations in Latin America, Africa, the Middle East, and Asia.

## Purification Process



First, the Net Filter removes large particles.



Second, the Sleeve Filter removes microparticles.



Third, the Purifying Filter eliminates bacteria, cysts, and viruses.



Finally, the Refining Filter removes chemicals and contaminants.

# What's Inside

You'll find everything you need to assemble your Outback Ready system inside. Improper assembly could damage the system. It is recommended to wash your hands before handling any components to keep the system sanitary.

If any parts are missing, please contact us at [customersupport@outbackwater.com](mailto:customersupport@outbackwater.com) or (844) 377-7873.



Purified Water Lid  
OB-LID5



Source Water Lid  
OB-LID2



Purified Water Container  
OB-PC5

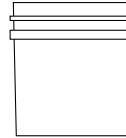

Source Water Container  
OB-SC2



Refining Filter  
OB-RF10



Purifying Filter  
OB-PF7



Net Filter  
OB-NET



Sleeve Filter  
OB-SLEEVE



Filter Connector Kit  
OB-FCG



Spigot Kit  
OB-SPIGOT

# 01

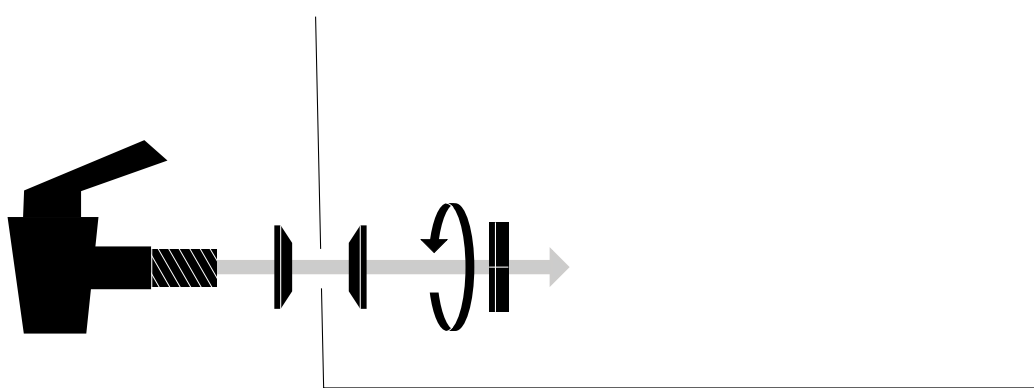

# 02

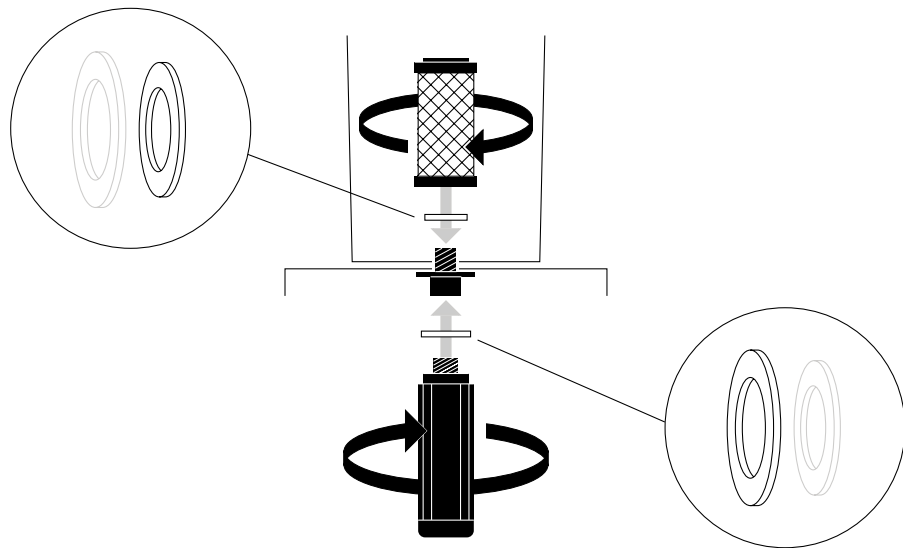
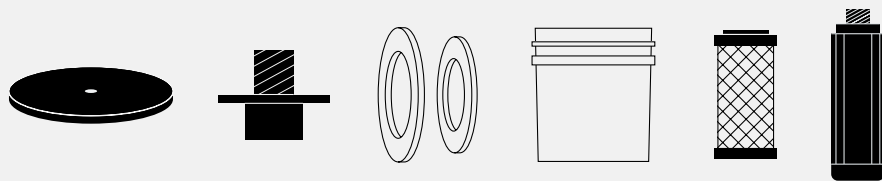

# 03

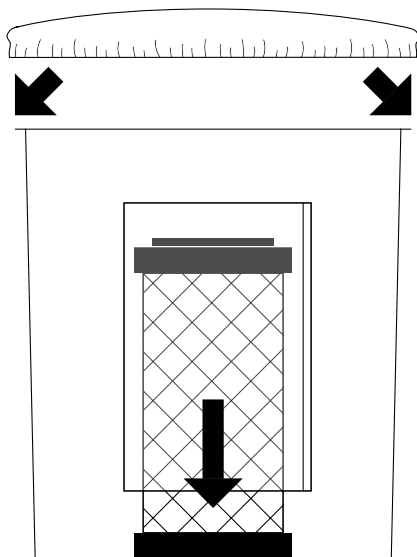
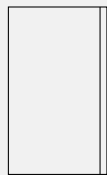

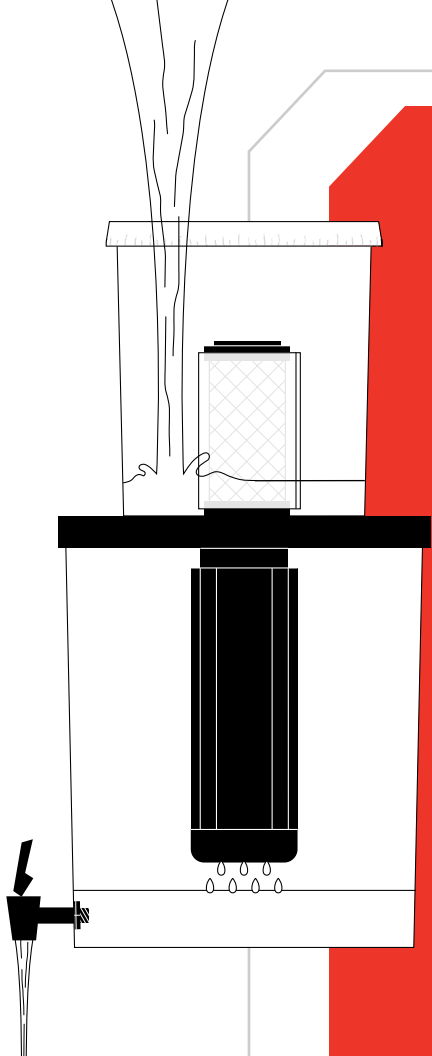

## Operation

1. Once the system is fully assembled, fill a collection pail with water from any tap, clear, or fresh moving water source. Do not use hot, salt, or brackish water.
2. Pour the water through the Net Filter and into the Source Water Container.
3. Wait. The water will be ready to drink as soon as it enters the Purified Water Container.

New or stored systems may take six hours or longer to purify the first batch of water depending on the water quality. Thereafter, it will purify roughly one gallon per hour. For the fastest filtering, continually keep the Source Water Container filled with water.

\* Do not use a filter that is cracked or broken.  
To ensure your water is safe, do not use a filter for longer than the capacity stated in this manual.

# Maintenance

Operating conditions impact how often a system needs to be cleaned. If you are using the system in a clean setting, the system should be cleaned at least once a week. Under more rugged conditions, clean your system at least twice a week and discard any unused, purified water stored for 72 hours or longer. Be sure to track your usage to ensure proper filter replacement.

## Cleaning Instructions

1. Using filtered water, rinse any dirt from inside the Source Water Container.
2. With clear water, rinse the Net Filter, Sleeve Filter, and Purifying Filter to remove debris.
3. Use a clean cloth dampened with a chlorine solution to wipe the inside of the containers and Spigot. Use ½ teaspoon of household bleach (5.5 - 6% Chlorine Hypochlorite) per 5 gallons of water.
4. Reassemble the system for operation.
5. Wipe away dirt or debris from the outside surface and rinse with clean water.

**NOTE:**

\*Except for the four filters, all surfaces can be exposed to hot, soapy water.

\*\*Maintenance and storage according to the manufacturer's instructions are essential for the performance and safety of the filtration system. Replace the filters according to the replacement schedule on page 8.

# Storage

## Long-Term Storage

For long-term storage of an unused system, keep in a cool, dry location out of direct sunlight.

## Long-Term Storage After Use

To store the system for more than a week after active use, flush the system with at least two gallons of clear water. Allow the Sleeve Filter and Purifying Filter to dry completely. Discard and replace the Refining Filter. Prior to using after the storage period, clean the Spigot and interior of the Purified Water Container and flush the system with at least two gallons of clear water.

## Short-Term Storage After Use

To store the system for brief periods of less than seven days after active use, flush the system with at least two gallons of clear water. Before resuming use, flush the system once more after the storage period.



# Replacement Schedule

## Net Filter

The Net Filter is durable and reusable. Clean the net using clear water and replace it when signs of wear appear, including fraying, change in weave, or exhaustion of the elastic.

## Sleeve Filter

The Sleeve Filter is reusable. If rinsing does not improve flow rate, replace.

## Refining Filter

Replace the Refining Filter after either (a) 1,800 gallons (6,500 liters) have been filtered, (b) 12 months of use, (c) a noticeable change in taste or odor, or (d) storage for more than seven days after active use.

## Purifying Filter

Replace the Purifying Filter after six months of use or if you experience a noticeable reduction in flow rate that is unable to be improved by the following steps:

1. Remove the Purifying Filter from the Filter Connector.
2. Hold the filter horizontally by its endcaps and gently tap it on a hard surface. Rotate and repeat several times to loosen larger particles trapped in the filter's surface.
3. Rinse the filter with clear water to remove any accumulated debris.



For replacements and filters, shop at [outbackwater.com](https://outbackwater.com)

# Product Details

Assembled: 24" x 11.75"

Boxed: 12" x 12" x 15"

Boxed: 7.00 lbs

## Weight

Empty: 6.75 lbs

When filled with water: 65 lbs

## Flow Rate

Up to 24 gallons per day<sup>1</sup>

## Capacity

Up to 1,800 gallons<sup>2</sup>

## Operating Temperature

42° F to 125° F

## Applications

Tap, clear, or fresh moving water source



1) The highest flow rate can be achieved by keeping the Source Water Container full for maximum gravity pressure. The flow rate may also vary depending on the quality of source water.  
2) Filter capacity and life expectancy may vary depending on the quality of source water. Specifications and capacities are subject to change without notice.

# Components List

Item	Parts Description
OB-NET	Net Filter
OB-SLEEVE	Sleeve Filter
OB-PF7	Purifying Filter
OB-RF10	Refining Filter
OB-FCG	Filter Connector Kit with Gaskets
OB-LID2	Source Water Lid
OB-LID5	Purified Water Lid
OB-SC2	Source Water Container
OB-PC5	Purified Water Container
OB-SPIGOT	Spigot Kit with Gaskets and Nut



## Need a Replacement?

Keep your setup flowing. Order needed parts using these part numbers on [outbackwater.com](http://outbackwater.com).

# Troubleshooting

Situation	Solution
Black dust in water	Harmless, loose particles of activated carbon appear as black dust in the Refining Filter. These particles can be removed by flushing water through the filter.
Flakes in cold water	Higher concentrations of harmless natural minerals in the water will solidify into flakes that appear when purified water freezes and later melts. The same minerals can also show up as deposits on pots when the water is boiled. Natural minerals are beneficial, and their presence does not pose a safety risk.
Slow flow rate	<p>This is a sign that the Purifying Filter or Refining Filter may be congested. First, check the Purifying Filter using the following steps:</p> <ol style="list-style-type: none"> <li>1. Remove the Source Water Container and Purified Water Lid with filters attached.</li> <li>2. Remove the Purifying Filter from the Filter Connector.</li> <li>3. Rinse and clean the Purifying Filter following the steps located on page 8.</li> <li>4. Reinstall and run two gallons of water through the system.</li> <li>5. If there is little to no water flow, replace the Purifying Filter.</li> <li>6. Reinstall the Refining Filter and check the flow rate.</li> <li>7. If the flow rate is still too slow, replace the Refining Filter.</li> </ol>
Unusual taste	Purified water with an unusual taste indicates the Refining Filter is near expiration and must be replaced.

**LIMITED WARRANTY:** The manufacturer warrants that the products sold hereunder will be free from defects in materials and workmanship under normal use for one year from the date of purchase. The purchaser's sole remedy shall be the repair or replacement of a defective component at no cost. The manufacturer will, at its sole discretion, repair or replace a defective product, provided that it is returned with proof of purchase to the manufacturer or your local distributor, postage prepaid, within the warranty period set forth above. All returns require a Return Authorization Number. This Limited Warranty will not apply to any product which has been improperly maintained or altered, incorrectly installed, misused, abused, or used for any application other than personal household use. EXCEPT TO THE EXTENT PROHIBITED BY APPLICABLE LAW, ALL IMPLIED WARRANTIES (INCLUDING WARRANTIES OF MERCHANTABILITY AND FITNESS FOR A PARTICULAR PURPOSE) SHALL BE LIMITED IN DURATION TO THE DURATION OF THIS LIMITED WARRANTY. THE LIMITED WARRANTY SET FORTH ABOVE IS IN LIEU OF ALL OTHER WARRANTIES, WHETHER EXPRESSED OR IMPLIED, INCLUDING ANY IMPLIED WARRANTY OF MERCHANTABILITY OR FITNESS FOR A PARTICULAR PURPOSE. THE MANUFACTURER SPECIFICALLY DISCLAIMS ANY RESPONSIBILITY OR LIABILITY FOR INCIDENTAL, INDIRECT, SPECIAL OR CONSEQUENTIAL DAMAGES, INCLUDING, BUT NOT LIMITED TO, LOSS OF PROFITS OR REVENUE, RESULTING FROM ANY BREACH OF EXPRESS OR IMPLIED WARRANTY OR CONDITION, OR UNDER ANY OTHER LEGAL THEORY, EVEN IF THE MANUFACTURER HAS BEEN ADVISED OF THE POSSIBILITY OF SUCH DAMAGES. This Limited Warranty shall be governed by the laws of the State of Texas, USA, without giving effect to any conflict of law principles that may provide the application of the law of another jurisdiction.

\*\*Consumers requiring water of special microbiological purity should follow the advice of their doctors and health officials regarding the consumption and use of water.

# Keep Your System Flowing



Replacement Filter Kit  
OB-RFK-25RDY



For replacements and filters,  
shop at [outbackwater.com](https://outbackwater.com)